



# TABOR & HARMONY HEAD START & EARLY HEAD START

14-2 Anna's Retreat  
ST. THOMAS, USVI



www.cphcorp.com  
A Full Service  
A & E Firm

Architects  
Engineers  
Landscape Architects  
M/E/P  
Planners  
Structural  
Surveyors  
Traffic / Transportation  
Development Coordination

Offices in:

- Florida
- Puerto Rico
- Connecticut
- Maryland

## DEMOLITION PERMIT SUBMISSION

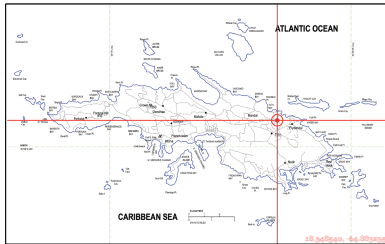

ISLAND MAP



LOCATION MAP



VICINITY MAP

FEDERAL CONSISTENCY ISSUE		Revision	By
Designed by:	C.G.N.		
Drawn by:	G.G.O.		
Checked by:	C.G.N.		
Approved by:	C. S. G.		
Scale:			
Date:	JUN/2022		
Job No.:	VST01/08		
© 2022		No.	Date

Plans Prepared by  
CPH, Inc.  
550 W. Flanders  
Sanford, FL 32271  
787-641-1992 (ext.7619)



Team Members							
<b>Architect</b> Contact: Ilker Uzun Email: iuzun@cphcorp.com Address: 1992 SW 1st Street Miami, FL, 33135 Phone: 305-274-4805	<b>Civil</b> Contact: Carlos Sanchez Email: csanchez@cphcorp.com Address: 950 Ponce De Leon Ave. San Juan, PR, 00907 Phone: 787-641-1992	<b>Structural</b> Contact: Jose Ortiz Email: jortiz@cphcorp.com Address: 950 Ponce De Leon Ave. San Juan, PR, 00907 Phone: 787-641-1992	<b>Mechanical</b> Contact: Jose A. Sanchez Email: chelo@jasconsultingpsc.com Address: Mechanical ADDRESS CITY, STATE, ZIPCODE Phone: 787-565-1588	<b>Specialty</b> Contact: TBD-Spec Contact Email: TBD-Spec Email Address: Specialty ADDRESS CITY, STATE, ZIPCODE Phone: TBD-Spec Phone	<b>Fire Alarm</b> Contact: TBD-F Alarm Contact Email: TBD-F Alarm Email Address: Fire Alarm ADDRESS CITY, STATE, ZIPCODE Phone: TBD-F Alarm Phone	<b>TBD-F Alarm Engineer</b> Contact: TBD-F Prot Contact Email: TBD-F Prot Email Address: Fire Protection ADDRESS CITY, STATE, ZIPCODE Phone: TBD-F Prot Phone	<b>TBD-F Prot Engineer</b> Contact: TBD-F Prot Contact Email: TBD-F Prot Email Address: Fire Protection ADDRESS CITY, STATE, ZIPCODE Phone: TBD-F Prot Phone
<b>Landscape</b> Contact: TBD-Land Contact Email: TBD-Land Email Address: Landscape ADDRESS CITY, STATE, ZIPCODE Phone: TBD-Land Phone	<b>Electrical</b> Contact: Juan R. Requena Email: jrequena@reengineers.com Address: F.O. Box 1911587 San Juan, PR, 00919 Phone: 787-763-0655	<b>Plumbing</b> Contact: Jose A. Sanchez Email: chelo@jasconsultingpsc.com Address: Plumbing ADDRESS CITY, STATE, ZIPCODE Phone: 787-565-1588	<b>Fire Protection</b> Contact: TBD-Spec Contact Email: TBD-Spec Email Address: TBD-Spec ADDRESS CITY, STATE, ZIPCODE Phone: TBD-Spec Phone				

NEW HEAD START  
BOLONGO  
No. 9 Bolongo  
FRENCHMAN'S BAY QTR., ST. THOMAS, U.S.V.I.

Sheet No.  
**GO.00**



INTERIOR VIEW OF BUILDING - ENTRY

8

ALL EXISTING ELECTRICAL FIXTURES, BOARDS, CONDUITS AND SUPPORT ACCESSORIES TO BE DEMOLISHED - CONTRACTOR TO ENSURE ELECTRICAL SERVICE IS NOT PRESENT AND NO VOLTAGE EXISTS

ALL EXISTING INTERIOR WALLS TO BE DEMOLISHED COMPLETELY - CONTRACTOR TO ENSURE ELECTRICAL SERVICE IS NOT PRESENT AND NO VOLTAGE EXISTS



VIEW TOWARDS BUILDING FROM STREET ENTRY

3

EXISTING BUILDING TO BE COMPLETELY DEMOLISHED - ROOF, WALLS, COLUMNS, SLAB, FOUNDATION

EXISTING WALKS TO BE COMPLETELY DEMOLISHED



AERIAL VIEW OF BUILDING

2

EXISTING WALKS TO BE COMPLETELY DEMOLISHED

EXISTING SEPTIC TANK TO BE EMPTIED AND COMPLETELY DEMOLISHED

EXISTING BUILDING TO BE COMPLETELY DEMOLISHED - ROOF, WALLS, COLUMNS, SLAB, FOUNDATION



VIEW TOWARDS BUILDING - LOWER WALKWAY

7

EXISTING BUILDING TO BE COMPLETELY DEMOLISHED - ROOF, WALLS, COLUMNS, SLAB, FOUNDATION

EXISTING WALKS TO BE COMPLETELY DEMOLISHED

EXISTING RETAINING WALL TO DEMOLISHED COMPLETELY



VIEW TOWARDS BUILDING - NORTHWEST CORNER

6

EXISTING BUILDING TO BE COMPLETELY DEMOLISHED - ROOF, WALLS, COLUMNS, SLAB, FOUNDATION

EXISTING STAIRS TO BE COMPLETELY DEMOLISHED



VIEW TOWARDS BUILDING - NORTHWEST SIDE

5

EXISTING BUILDING TO BE COMPLETELY DEMOLISHED - ROOF, WALLS, COLUMNS, SLAB, FOUNDATION



VIEW TOWARDS BUILDING - FRONT

4



EXISTING CONDITIONS SURVEY

1

STATION	NORTHING	EASTING	DESCRIPTION
1	845528.000	1182001.916	487.462
2	845528.000	1182001.916	487.462

STATION	NORTHING	EASTING	DESCRIPTION
1	845528.000	1182001.916	487.462
2	845528.000	1182001.916	487.462

LIMIT OF DEMOLITION WORKS	
	LIMIT OF DEMOLITION WORKS
	TEMPORARY CONSTRUCTION BARRIER
	DEMOLITION ORDER
	TWO STORY BUILDING TO BE DEMOLISHED
	ONE STORY BUILDING TO BE DEMOLISHED
	DEMOLITION RELATED EXCAVATION
	CONCRETE PAVING, SIDEWALK, DRIVEWAY TO BE DEMOLISHED
	CAMERA VIEW ID
	PICTURE ID
	DIRECTION OF VIEW

**cph**  
www.cphcorp.com  
A Full Service A & E Firm  
Architects  
Engineers  
Landscape Architects  
M/E/P  
Planners  
Structural  
Surveyors  
Traffic/Transportation  
Development Coordination

Offices in:  
• Florida  
• Puerto Rico  
• Connecticut  
• Maryland

**FEDERAL CONSISTENCY ISSUE**

Plan Prepared by: OPM, Inc.  
500 W. Palm Jc. Blvd., Suite 1110  
P.O. Box 11902, Fort Lauderdale, FL 33324

NEW HEAD START BOLONGO  
No. 9 Bolongo  
FRENCHMAN'S BAY QTR., ST. THOMAS, U.S.V.I.

Sheet No. **D1.01**

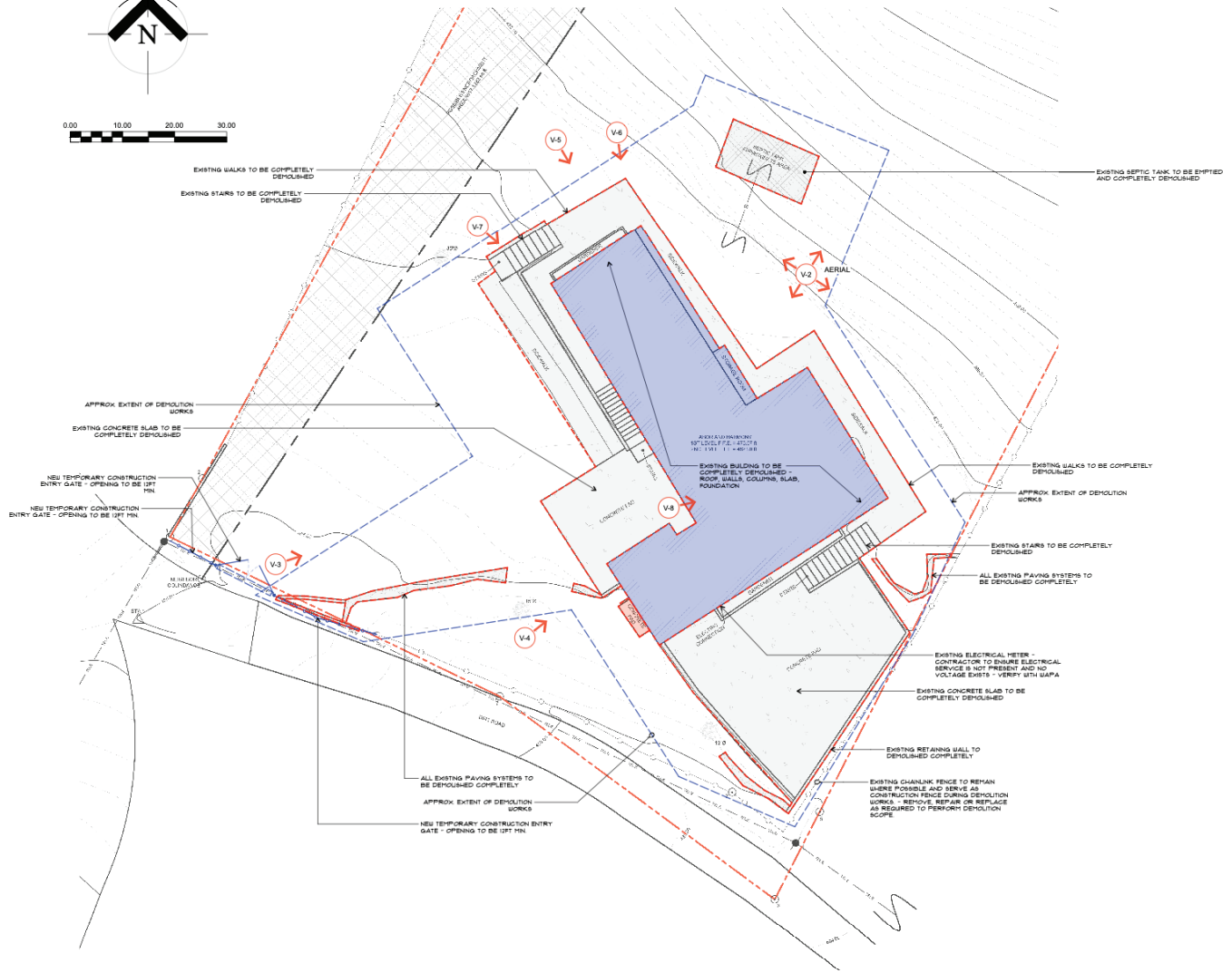
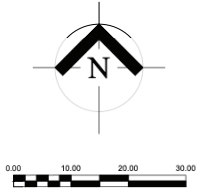

**GENERAL DEMOLITION NOTES**

1. THIS DEMOLITION PLAN SHOWS THE EXTENTS OF EXISTING BUILDINGS, EXTERIOR STAIRS, AND OTHER SITE ELEMENTS. THE CONTRACTOR SHALL EXAMINE THE BUILDING AND WORK SHOWN BY ALL CONTRACT DOCUMENTS TO DETERMINE SCOPE OF DEMOLITION WORK, REQUIRED WHETHER SPECIFICALLY SHOWN OR NOT.
2. CONTRACTOR TO ENSURE THAT ALL DEMOLITION DEBRIS IS REMOVED FROM SITE AND DISPOSED OF IN A LEGAL MANNER.
3. MATERIAL HAVING RECYCLABLE VALUE SHALL BECOME THE PROPERTY OF THE OWNER. ALL OTHER MATERIAL AND DEBRIS ACCUMULATED AS A RESULT OF DEMOLITION SHALL BECOME THE PROPERTY OF THE CONTRACTOR AND SHALL BE REMOVED FROM THE PREMISES BY THE CONTRACTOR AND DISPOSED OF IN A LEGAL AND PROPER MANNER.
4. CONTRACTOR TO FURNISH, INSTALL, AND MAINTAIN IN SAFE CONDITIONS AT ALL TIMES THAT TEMPORARY PROTECTION IS REQUIRED TO ENSURE SAFETY FOR PERSONS AND PROPERTY DURING DEMOLITION AND REMOVAL WORK.
5. CONTRACTOR TO REMOVE ALL EXISTING ELECTRICAL OUTLETS AND WIRING AS REQUIRED IN WALLS, FLOORS AND FURNISHINGS TO BE DEMOLISHED.
6. CONTRACTOR TO REMOVE ALL PLUMBING FIXTURES, FITTINGS AND PIPING AS REQUIRED IN WALLS, FLOORS AND FURNISHINGS TO BE DEMOLISHED.
7. ALL ELECTRICAL PLUMBING AND MECHANICAL WORK (DEMOLITION AND NEW) SHALL BE PERFORMED BY LICENSED, COMPETENT CONTRACTORS.
8. CONTRACTOR SHALL BE RESPONSIBLE FOR ARRANGING THE SHUT OFF OF ANY EXISTING UTILITIES.
9. CONTRACTOR TO ENSURE THAT ALL WORK IS PERFORMED IN THE BEST WORKMANSHIP POSSIBLE IN ACCORDANCE WITH EACH TRADE'S BEST INDUSTRY STANDARDS.

**cph**  
www.cphcorp.com  
A Full Service  
A & E Firm  
Architects  
Engineers  
Landscape Architects  
M / E / P  
Planners  
Structural  
Surveyors  
Traffic / Transportation  
Development Coordination  
Offices in:  
• Florida  
• Puerto Rico  
• Connecticut  
• Maryland



**FEDERAL  
CONSISTENCY  
ISSUE**

Discipline	Checked By	Approved By	Scale	Date	Job No.	No.	Date
C.G.N.	G.G.O.	C.S.G.	C.S.G.	JUN/2022	V101.08	1	

Plans Prepared By  
OPM, Inc.  
550 W. Palms Bl.  
Sanford, FL 32271  
787.641.1992 (Ext. 7619)

**NEW HEAD START  
BOLONGO**  
No. 9 Bolongo  
FRENCHMAN'S BAY QTR., ST. THOMAS, U.S.V.I.

**LEGEND**

	LIMIT OF DEMOLITION WORKS
	TEMPORARY CONSTRUCTION BARRIER
	DEMOLITION ORDER
	TWO STORY BUILDING TO BE DEMOLISHED
	ONE STORY BUILDING TO BE DEMOLISHED
	DEMOLITION RELATED EXCAVATION
	CONCRETE PAVING, SIDEWALK DRIVEWAY TO BE DEMOLISHED
	CAMERA VIEW 1/2
	PICTURE ID DIRECTION OF VIEW

**DEMOLITION SITE PLAN**



**ARCHITECTURAL SITE PLAN**

**1**



www.cphcorp.com  
 A Full Service  
 A & E Firm  
 Architects  
 Engineers  
 Landscape Architects  
 M/E/P  
 Planners  
 Structural  
 Surveyors  
 Traffic / Transportation  
 Development Coordination

- Offices in:
- Florida
  - Puerto Rico
  - Connecticut
  - Maryland



Revision	By

Dispersed By:	C.G.N.	G.G.O.	C.G.N.	C.S.G.	JUN/2022	V5101.08	No.	Date
Drawn by:								
Checked by:								
Approved by:								
Scale:								
Date:								
Job No.:								
© 2022								

Plans Prepared by  
 CPH, Inc.  
 555 W. Federal St.  
 Sanford, FL 32271  
 787.641.1992 (ext.7619)

**NEW HEAD START  
 BOLOGNO**  
 No. 9 Bologno  
 FRENCHMAN'S BAY QTR., ST. THOMAS, U.S.V.I.

Sheet No.  
**A0.01**