

PROPERTY  
STANDARDS AVIATION  
FUEL FARM  
PARCEL NO. 70-AA  
ESTATE UNDERSE BAY  
NO. 44 SOUTHSHORE DRIVE  
ST. THOMAS  
U.S. VIRGIN ISLANDS

**SITE PLAN:  
EROSION & SEDIMENT  
CONTROL NOTES**

NO.	REVISIONS	DATE

**PAUL  
FERRERAS, PE**  
STRUCTURAL ENGINEER  
P.O. Box 6001 122  
St. Thomas, VI 00801  
Phone (340) 777-5779  
Fax (340) 777-5779  
e-mail paul@pffpe.com  
NEW YORK LICENSE: No. 038490  
NEW JERSEY LICENSE: GE 32849  
FLORIDA LICENSE: No. 95408  
VIRGIN ISLANDS LICENSE: No. A4142



ALL INFORMATION CONTAINED  
HEREIN IS THE PROPERTY OF PAUL  
FERRERAS. NO PART OF THIS  
DRAWING AND DETAILS AS SHOWN ON THE  
DRAWING IS TO BE REPRODUCED, COPIED,  
INCORPORATED AND REPRODUCED FOR  
USE ON THE SPECIFIC PROJECT  
UNLESS THE CONTRACTOR OBTAINS THE  
WRITTEN PERMISSION OF PAUL FERRERAS.  
ANY REUSE WITHOUT THE WRITTEN  
PERMISSION OF PAUL FERRERAS  
WILL BE AT THE USER'S SOLE RISK AND  
TO OBTAIN COPIES FOR LIMITED  
REFERENCE PURPOSES ONLY.

DATE  
21 June, 2021  
SCALE  
As Shown  
2 OF 6  
**G2**

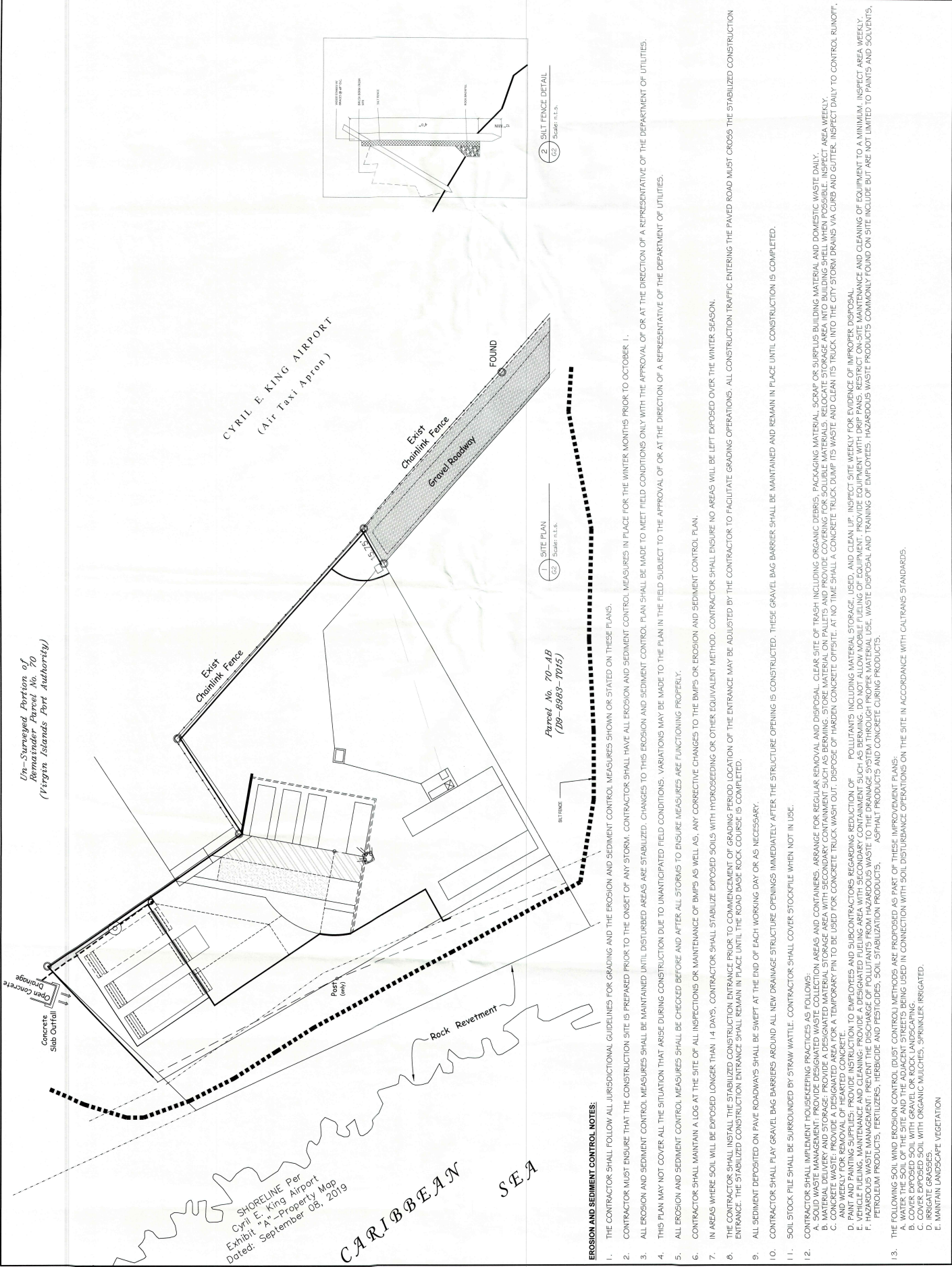

**EROSION AND SEDIMENT CONTROL NOTES:**

1. THE CONTRACTOR SHALL FOLLOW ALL JURISDICTIONAL GUIDELINES FOR GRADING AND THE EROSION AND SEDIMENT CONTROL MEASURES SHOWN OR STATED ON THESE PLANS.
2. CONTRACTOR MUST ENSURE THAT THE CONSTRUCTION SITE IS PREPARED PRIOR TO THE ONSET OF ANY STORM. CONTRACTOR SHALL HAVE ALL EROSION AND SEDIMENT CONTROL MEASURES IN PLACE FOR THE WINTER MONTHS PRIOR TO OCTOBER 1.
3. ALL EROSION AND SEDIMENT CONTROL MEASURES SHALL BE MAINTAINED UNTIL DISTURBED AREAS ARE STABILIZED. CHANGES TO THIS EROSION AND SEDIMENT CONTROL PLAN SHALL BE MADE TO MEET FIELD CONDITIONS ONLY WITH THE APPROVAL OF OR AT THE DIRECTION OF A REPRESENTATIVE OF THE DEPARTMENT OF UTILITIES.
4. THIS PLAN MAY NOT COVER ALL THE SITUATION THAT ARISE DURING CONSTRUCTION DUE TO UNANTICIPATED FIELD CONDITIONS. VARIATIONS MAY BE MADE TO THE PLAN IN THE FIELD SUBJECT TO THE APPROVAL OF OR AT THE DIRECTION OF A REPRESENTATIVE OF THE DEPARTMENT OF UTILITIES.
5. ALL EROSION AND SEDIMENT CONTROL MEASURES SHALL BE CHECKED BEFORE AND AFTER ALL STORMS TO ENSURE MEASURES ARE FUNCTIONING PROPERLY.
6. CONTRACTOR SHALL MAINTAIN A LOG AT THE SITE OF ALL INSPECTIONS OR MAINTENANCE OF BMPs AS WELL AS ANY CORRECTIVE CHANGES TO THE BMPs OR EROSION AND SEDIMENT CONTROL PLAN.
7. IN AREAS WHERE SOIL WILL BE EXPOSED LONGER THAN 14 DAYS, CONTRACTOR SHALL STABILIZE EXPOSED SOILS WITH HYDROSEEDING OR OTHER EQUIVALENT METHOD. CONTRACTOR SHALL ENSURE NO AREAS WILL BE LEFT COVERED OVER THE WINTER SEASON.
8. THE CONTRACTOR SHALL INSTALL THE STABILIZED CONSTRUCTION ENTRANCE PRIOR TO COMMENCEMENT OF GRADING PERIOD. LOCATION OF THE ENTRANCE MAY BE ADJUSTED BY THE CONTRACTOR TO FACILITATE GRADING OPERATIONS. ALL CONSTRUCTION TRAFFIC ENTERING THE PAVED ROAD MUST CROSS THE STABILIZED CONSTRUCTION ENTRANCE. THE STABILIZED CONSTRUCTION ENTRANCE SHALL REMAIN IN PLACE UNTIL THE ROAD BASE ROCK COURSE IS COMPLETED.
9. ALL SEDIMENT DEPOSITED ON PAVE ROADWAYS SHALL BE SWEEP AT THE END OF EACH WORKING DAY OR AS NECESSARY.
10. CONTRACTOR SHALL PLACE GRAVEL BAG BARRIERS AROUND ALL NEW DRAINAGE STRUCTURE OPENINGS IMMEDIATELY AFTER THE STRUCTURE OPENING IS CONSTRUCTED. THESE GRAVEL BAG BARRIERS SHALL BE MAINTAINED AND REMAIN IN PLACE UNTIL CONSTRUCTION IS COMPLETED.
11. SOIL STOCK PILE SHALL BE SURROUNDED BY STRAW BATTLE. CONTRACTOR SHALL COVER STOCKPILE WHEN NOT IN USE.
12. CONTRACTOR SHALL IMPLEMENT HOUSEKEEPING PRACTICES AS FOLLOWS:  
A. SOLID WASTE MANAGEMENT: PROVIDE DESIGNATED WASTE COLLECTION AREAS AND CONTAINERS. ARRANGE FOR REGULAR REMOVAL AND DISPOSAL. CLEAR SITE OF TRASH INCLUDING ORGANIC DEBRIS. PACKAGING MATERIAL, SCRAP OR SURPLUS BUILDING MATERIAL AND DOMESTIC WASTE DAILY.  
B. MATERIAL DELIVERY AND STORAGE: PROVIDE A DESIGNATED MATERIAL STORAGE AREA WITH SECONDARY CONTAINMENT SUCH AS BERMING. STORE MATERIAL ON PALLETS AND PROVIDE COVERING FOR SOLUBLE MATERIALS. RELOCATE STORAGE AREA INTO BUILDING SHELL WHEN POSSIBLE. INSPECT AREA WEEKLY.  
C. CONCRETE WASTE: PROVIDE A DESIGNATED AREA FOR A TEMPORARY PIN TO BE USED FOR CONCRETE TRUCK WASH OUT. DISPOSE OF HARDEN CONCRETE OFFSITE. AT NO TIME SHALL A CONCRETE TRUCK DUMP ITS WASTE AND CLEAN ITS TRUCK INTO THE CITY STORM DRAINS VIA CURB AND GUTTER. INSPECT DAILY TO CONTROL RUNOFF. AND WEEKLY FOR REMOVAL OF HEARTED CONCRETE.  
D. PAINT AND PAINTING SUPPLIES: PROVIDE INSTRUCTION TO EMPLOYEES AND SUBCONTRACTORS REGARDING REDUCTION OF POLLUTANTS INCLUDING MATERIAL STORAGE, USED, AND CLEAN UP. INSPECT SITE WEEKLY FOR EVIDENCE OF IMPROPER DISPOSAL.  
E. EQUIPMENT MAINTENANCE: PROVIDE EQUIPMENT WITH PROPER MAINTENANCE AND CLEANING OF EQUIPMENT TO A MINIMUM. INSPECT AREA WEEKLY.  
F. HAZARDOUS WASTE MANAGEMENT: PREVENT THE DISCHARGE OF POLLUTANTS FROM HAZARDOUS WASTE TO THE DRAINAGE SYSTEM THROUGH PROPER MATERIAL USE, WASTE DISPOSAL AND TRAINING OF EMPLOYEES. HAZARDOUS WASTE PRODUCTS COMMONLY FOUND ON SITE INCLUDE BUT ARE NOT LIMITED TO PAINTS AND SOLVENTS, PETROLEUM PRODUCTS, FERTILIZERS, HERBICIDE AND PESTICIDES, SOIL STABILIZATION PRODUCTS, ASPHALT PRODUCTS AND CONCRETE CURING PRODUCTS.
13. THE FOLLOWING SOIL WIND EROSION CONTROL (DUST CONTROL) METHODS ARE PROPOSED AS PART OF THESE IMPROVEMENT PLANS:  
A. COVER EXPOSED SOIL WITH GRAVEL OR ROCK STRIPPS.  
B. COVER EXPOSED SOIL WITH ORGANIC MULCHES, SPRINKLER, IRRIGATED.  
C. COVER EXPOSED SOIL WITH GRAVEL OR ROCK STRIPPS.  
D. IRRIGATE GRASSSEEDS.  
E. MAINTAIN LANDSCAPE VEGETATION

When dimensions have precedence over text dimensions, Contractor shall verify and be responsible for all dimensions and conditions on the plans. Paul Ferreras, PE, must be notified immediately in writing of any variation from the dimensions and conditions shown on the plans. Paul Ferreras, PE, shall verify all conditions prior to typing out or fabricating work. In the event of unauthorized use of these documents by a third party, the third party shall hold Paul Ferreras, PE, harmless and agrees to reimburse Paul Ferreras, PE, for such use in an amount equal to the original fee. The original documents, plus 10% fees, contract fees and other costs, shall be returned to Paul Ferreras, PE, upon completion of the project. Paul Ferreras, PE, reserves the right to provide or withhold any information or documents that are not specifically requested in writing. Paul Ferreras, PE, reserves the right to provide or withhold any information or documents that are not specifically requested in writing. Paul Ferreras, PE, reserves the right to provide or withhold any information or documents that are not specifically requested in writing. Paul Ferreras, PE, reserves the right to provide or withhold any information or documents that are not specifically requested in writing.

# GRADING PLAN

PROPERTY  
STANDARD AVIATION  
FUEL TANK  
PARCEL NO. 70-AB  
ESTATE LINDBERG BAY  
INC. - 44 SOUTHSHORE LANE  
ST. THOMAS  
U.S. VIRGIN ISLANDS

NO.	REVISIONS	DATE

**PAUL FERRERAS, PE**  
STRUCTURAL ENGINEER  
P.O. Box 600122  
St. Thomas, VI 01101  
Phone (340) 714-5435  
Fax (340) 777-5779  
e-mail: paul@pffpe.pro  
NEW YORK LICENSE No. 039450  
NEW JERSEY LICENSE GE 32949  
FLORIDA LICENSE No. 56406  
VIRGIN ISLANDS LICENSE No. 491 F



THE INFORMATION CONTAINED HEREIN IS THE PROPERTY OF PAUL FERRERAS, PE. IT IS TO BE USED ONLY FOR THE PROJECT AND SITE SPECIFICALLY IDENTIFIED IN THE DOCUMENTS WERE CREATED. IT IS NOT TO BE REPRODUCED, COPIED, OR TRANSMITTED IN ANY FORM OR BY ANY MEANS, ELECTRONIC OR MECHANICAL, WITHOUT THE WRITTEN CONSENT OF PAUL FERRERAS, PE. THE OWNER SHALL BE PERMITTED TO REPRODUCE THIS INFORMATION FOR REFERENCE PURPOSE ONLY.

DATE: 29 June, 2022  
SCALE: AS NOTED  
SHEET NO: 3 OF 6

Un-Surveyed Portion of  
Remainder Parcel No. 70  
(Virgin Islands Port Authority)

Parcel No. 70-AB  
(D9-8983-7015)

**LEGEND**

	STANDARD AVIATION NEW 7' x 1' CHAIN LINK FENCE GALVANIZED
	GATE SLIDING
	EXISTING CHAIN LINK

CYRIL E. KING  
(Air Taxi Aprd)

Exist  
Chainlink Fence  
Gravel Roadway  
PUBLIC ENTRY

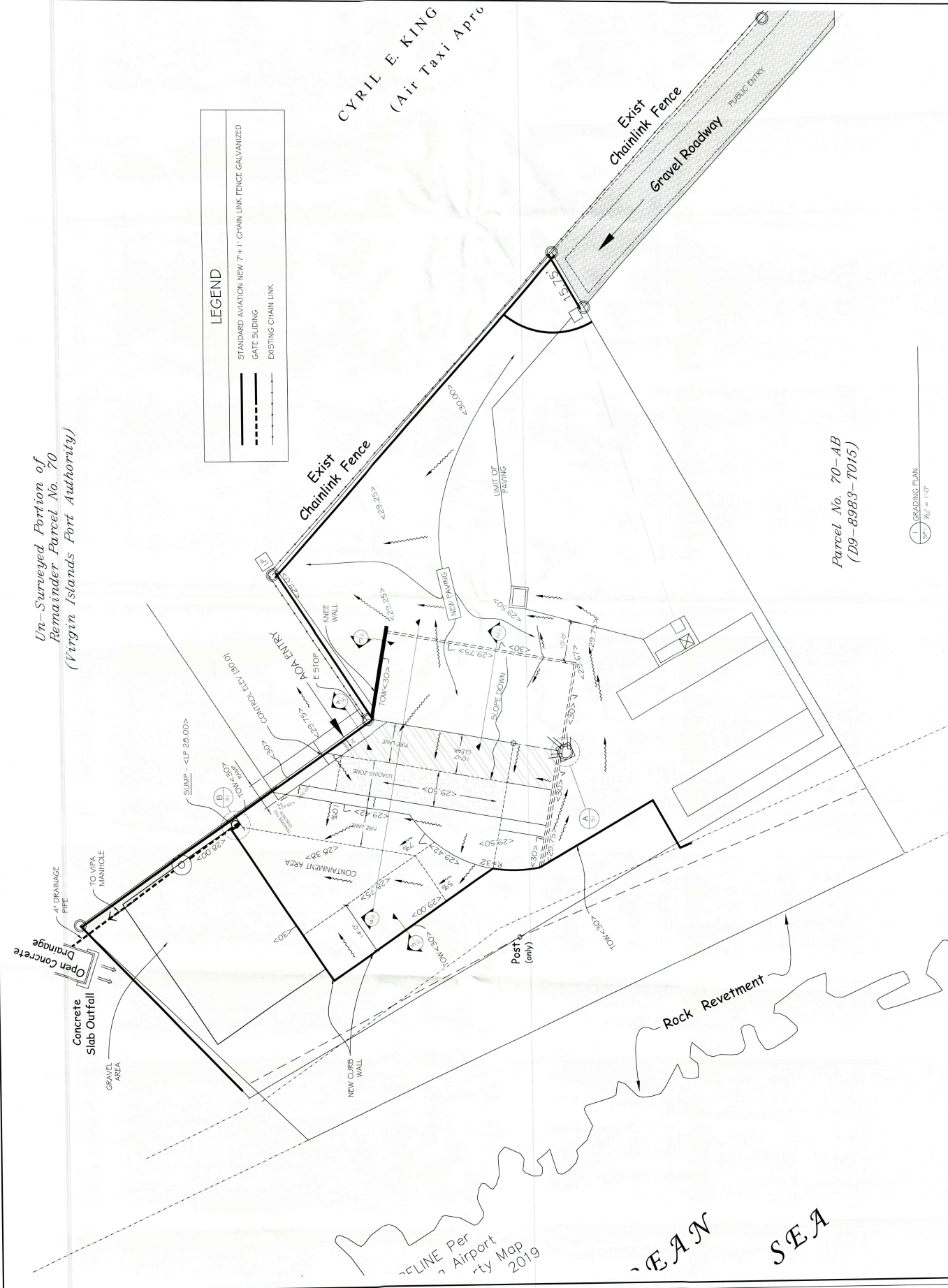

1 GRADING PLAN  
SCALE: 1" = 10'

PROPERTY  
STANDARDS AVIATION  
FUELL FARM  
PARCEL NO. 70-AA  
ESTATE LINDSBERG BAY  
NO. 4A SOUTHWEST CORN  
ST. THOMAS  
U.S. VIRGIN ISLANDS

# PROPOSED PORT AUTHORITY PAVEMENT PLAN

NO.	REVISIONS	DATE

**PAUL  
FERRERAS, PE**  
STRUCTURAL ENGINEER  
P.O. Box 6000 | 222  
St. Thomas, USVI 00801  
Phone: (340) 777-5779  
Fax: (340) 777-5779  
e-mail: paul@pfrpe.pro  
NEW YORK LICENSE: No. 0394450  
NEW JERSEY LICENSE: GE 528449  
FLORIDA LICENSE: No. 564205  
VIRGIN ISLANDS LICENSE: No. 4431 E



ALL INFORMATION CONTAINED  
HEREIN IS THE PROPERTY OF PAUL  
FERRERAS. IT IS TO BE USED ONLY  
AS INDICATED ON THE DRAWINGS  
AND DOCUMENTS. NO REPRODUCTION  
OR TRANSMISSION OF THIS  
DOCUMENT IS PERMITTED WITHOUT THE  
WRITTEN CONSENT OF PAUL  
FERRERAS. ANY REPRODUCTION  
OR TRANSMISSION OF THIS  
DOCUMENT WITHOUT THE WRITTEN  
CONSENT OF PAUL FERRERAS IS  
PROHIBITED. THIS DOCUMENT IS  
FOR REFERENCE PURPOSE ONLY.

DATE: 29 June, 2022  
SCALE: AS NOTED  
AS NOTED: 5 OF 6  
**SP3**

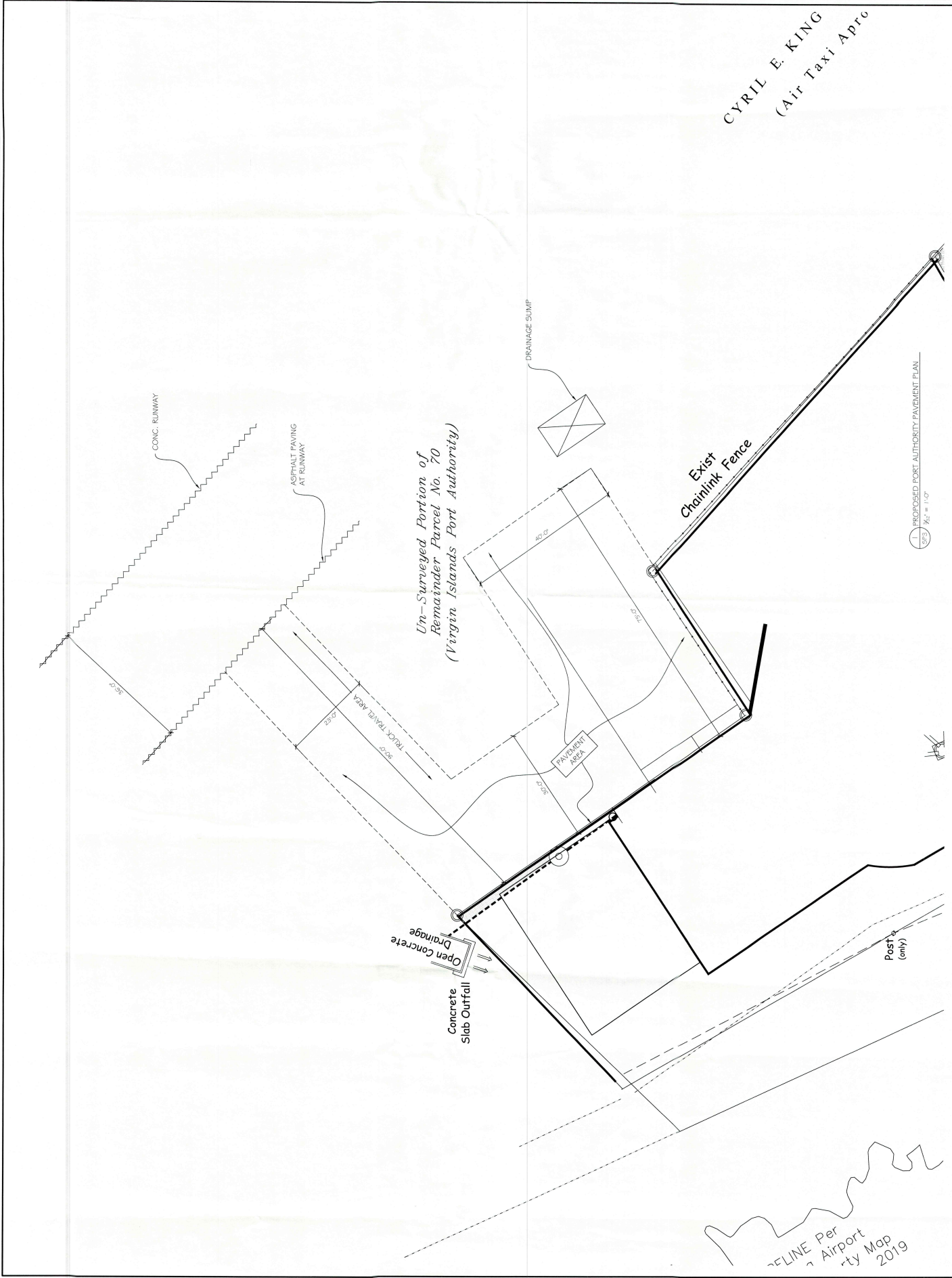

Written drawings have precedence over scaled dimensions. Contractor shall verify and be responsible for all dimensions and conditions on the project. Paul Ferreras, PE must be notified immediately in writing of any variation from the dimensions and conditions shown on the plans. Field verify all conditions prior to laying out or installing work. Bring to the Engineer's attention any deviations from detailed conditions and field conditions prior to proceeding with any work and coordinate with Engineer to modify such conditions as additional work to the owner. Engineer or consultant. Shop drawings must be submitted to the Engineer and reviewed by the Engineer prior to ordering materials. Station and delivery to the site, unless otherwise provided for under the specific contractual agreement between the Engineer and Client. Paul Ferreras, PE expressly reserves its common law copyright and other property rights in these documents. These documents are not to be reproduced, changed or copied in any form or manner whatsoever for any third party without the written permission and/or written consent of Paul Ferreras, PE. In the event of unauthorized use of these documents by a third party, the third party shall hold Paul Ferreras, PE harmless and agrees to remunerate Paul Ferreras, PE for such use in an amount equal to the original fee. For the original documents, plus legal fees, court costs, collection fees and other costs.